

SPECIFICATIONS

Section 1: POOL DATA

- TOTAL SQUARE FEET = 2,276
- TOTAL PERIMETER FEET = 232
- TOTAL GALLONS = 48,900
- TURN OVER TIME = < 5 HOURS
- TURN OVER RATE = 115 GPM @ 70 TDH
- POOL DIMENSIONS = VARIES (REFER PLAN)
- POOL DEPTH = 0' - 10' / 30" - 4'9"

Section 2: POOL EQUIPMENT

- PUMP: (2) 3.0HP FILTER PUMPS
- PUMP: (2) 1.5 HP (WATER FEATURES)
- FILTER: (2) COMMERCIAL SAND FILTERS
- MAIN DRAINS (1) SET 18" GRATES W/ 3.0" SUCTION LINES
- LIGHTS: (4) 500 WATT
- FLOWMETER: 0-140 GPM
- SKIMMERS: (5) STANDARD RETURNS: (8) STANDARD
- (6) FOUNTAIN JETS (RPWJ-PDJ ROMAN FOUNTAINS)
- (2) ALLIGATOR TOY (VOR1102 BY VORTEX)
- (1) SPIN AND SPLASH DOME TOY (VOR7531 BY VORTEX)
- CHLORINATOR: IN-LINE
- HANDICAP LIFT: STAINLESS STEEL SLEEVE
- STAINLESS STEEL LADDER

Section 3: DECK DATA

- TOTAL SQUARE FEET = 2,966
- MATERIAL: AGGREGATE
- DECK PITCH < 1/4" PER FT.
- DECK DRAINS AS NEEDED

Section 4: REINFORCING SCHEDULE

- BOND BEAM: 4-#4 CONTINUOUS - DEFLECT BEAM REINF CONTINUOUS UNDER SKIMMERS
- POOL WALLS: 8" THICK W/ #4 @ 8" EW
- LAP BARS 1-6" AT SPLICES
- SEE DETAILS FOR ADDITIONAL INFO

Section 5: OTHER DATA

- INCLUDES ALL PERMITS AND ENGINEERING FEES AND SUBMITTALS FOR APPROVAL
- MAIN DRAINS IN POOL HAVE 18" SQUARE GRATE COVERS MEETING THE REQUIREMENTS OF THE VIRGINIA GRAEME BAKER POOL AND SPA SAFETY ACT, BEING IN COMPLIANCE WITH ASME/ANSI A112.19.8-2007
- STAINLESS STEEL HANDRAIL AT STEPS
- ALL STEPS AND SEATS TO HAVE 2" BAND OF TILE
- ALL REQUIRED DEPTH MARKERS
- "NO DIVING" MARKERS @ 25' MAX SPACING
- ALL EQUIPMENT TO BE NNSF APPROVED
- AUTO-FILL FOR POOL SHALL BE CONNECTED TO FRESHWATER WITH APPROVED BACK-FLOW PREVENTION DEVICE
- BONDING - GROUNDING ELECTRONICALLY CONNECT A CONTINUOUS #8 BAR
- WIRE LOOP WITH 0B CLAMPS. ATTACH LOOP TO SHELL REINFORCING BARS
- THIS POOL MEETS OR EXCEEDS STATE HEALTH STANDARDS
- REMOVE EXISTING KID POOL

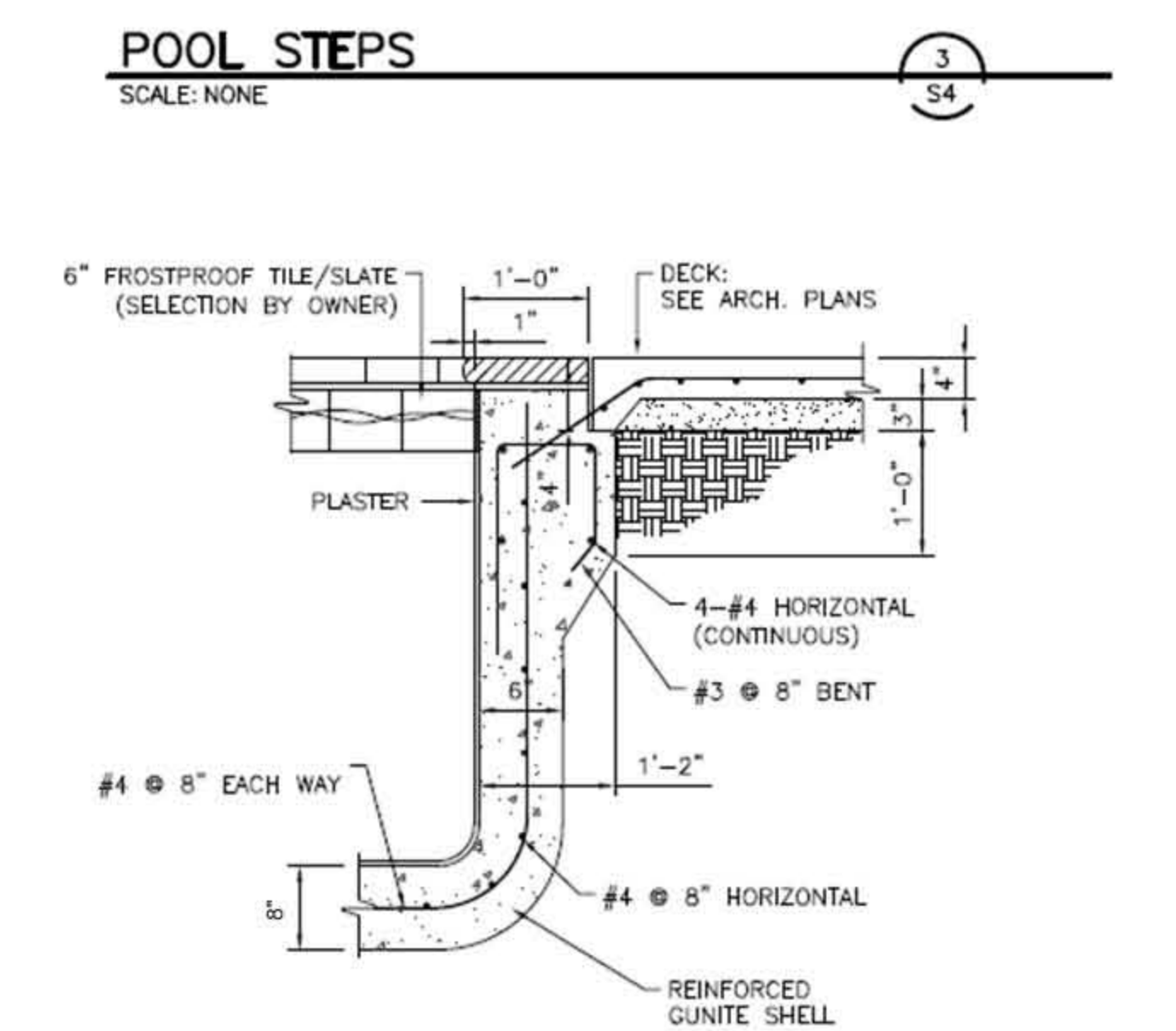
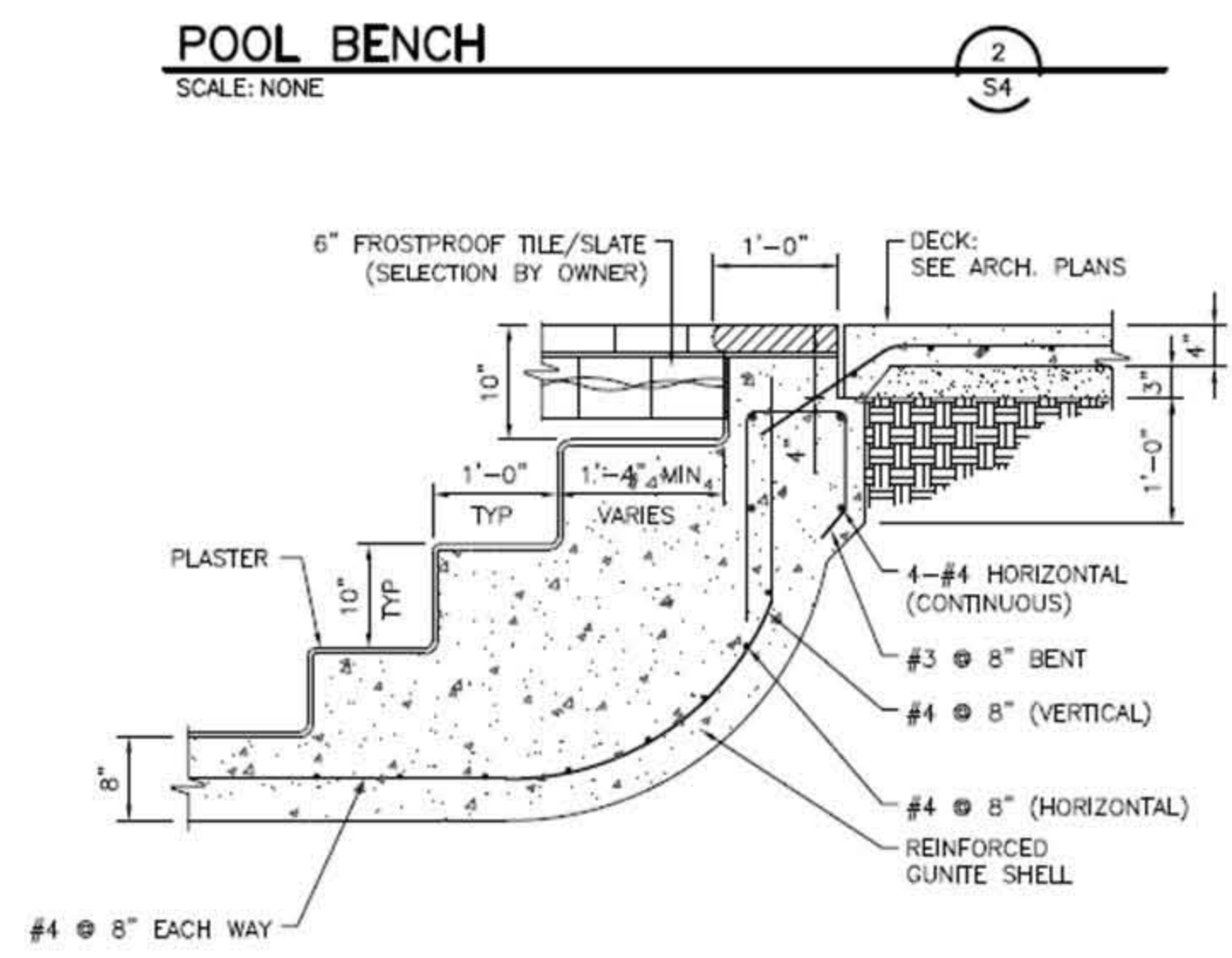
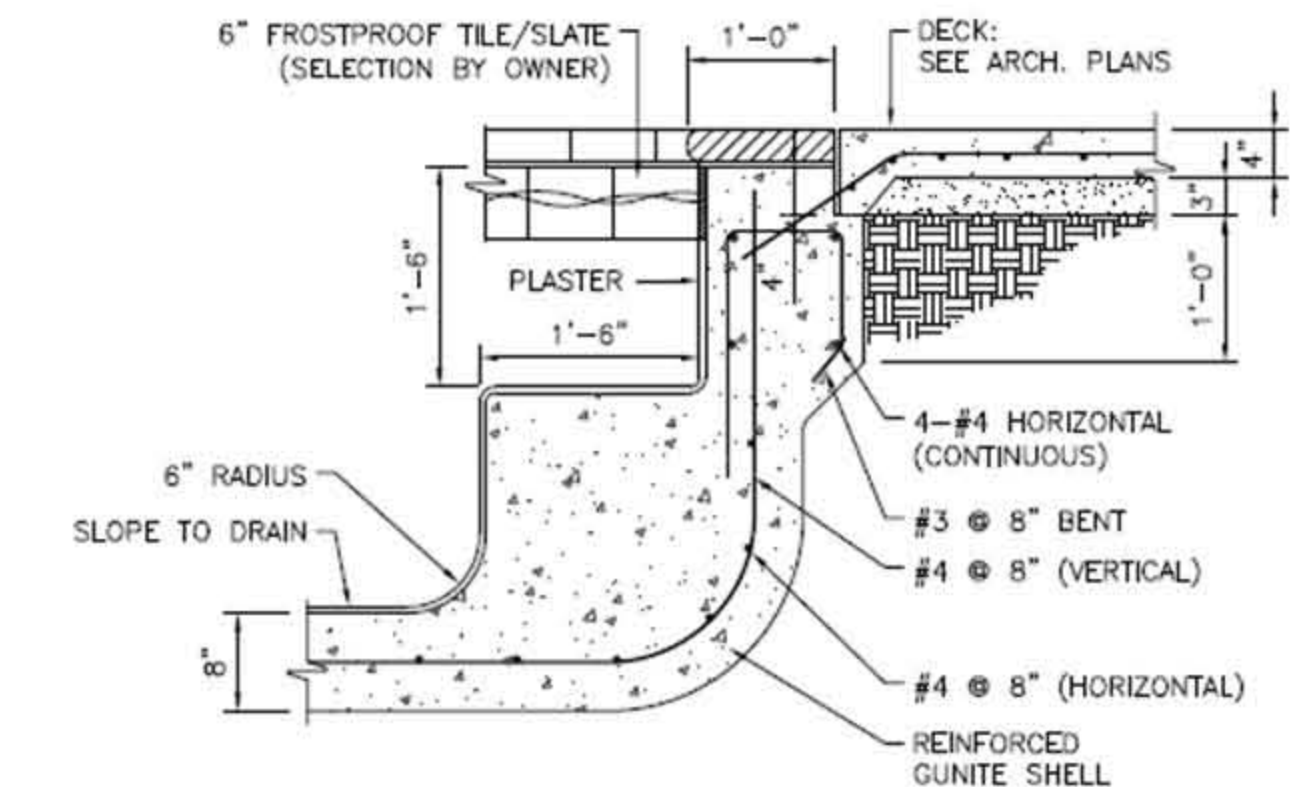
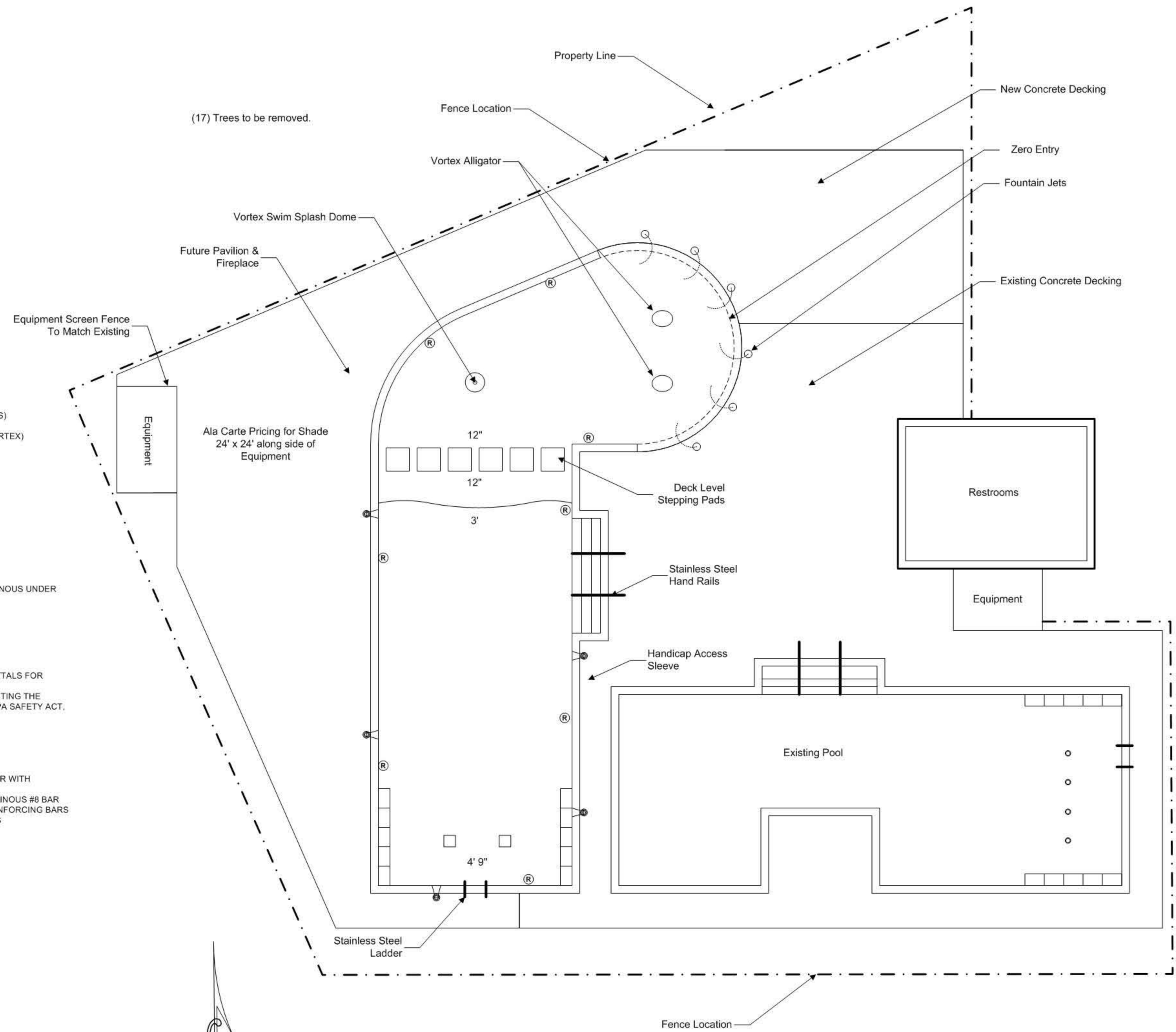

www.goldmedalpools.com

GOLD MEDAL POOLS
4326 Preston Road Frisco, Texas 75034
972-712-4653(Gold)

PANTHER CREEK COMMUNITY POOL
Frisco, Tx

THIS DRAWING IS THE PROPERTY OF GOLD MEDAL POOLS & SPAS AND MAY NOT BE USED FOR THE DESIGN OR CONSTRUCTION OF A POOL OR SPA WITHOUT THE EXPRESS WRITTEN PERMISSION OF STEVE SANDLER'S GOLD MEDAL POOLS AND SPAS

Plan Dated: 7/20/10
POOL & SITE PLAN
SCALE 1/8" = 1'-0"
WET DOWN GUNITE AT LEAST TWICE DAILY FOR 7 DAYS. DO NOT TURN ON POOL LIGHT WHEN THE POOL IS EMPTY

Date	Addendum	Item

Legal Description	
Lot No. _____	Bk. No. _____
Addition Panther Creek	
Permit Office Frisco, Texas	
Mgr. Josh Sandler	
Salesman _____	

